

# Nubez 5x5

RECESSED

TYPE  
PROJECT

## Overview

- Soft even illumination - Newmat Stretch Ceiling is a PVC membrane diffuser
- No sagging the way acrylic does in 4x4, 5x5, 6x6 applications
- Extruded aluminum door frame
- Also available in surface mount

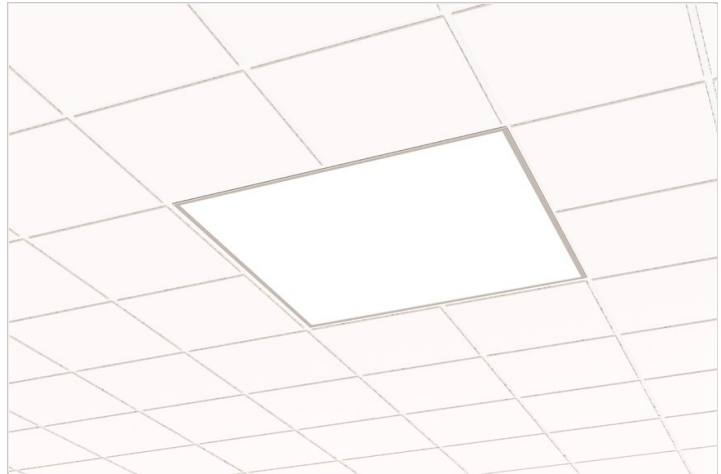

## Ordering Format

PART NUMBER: NUB-R

Size	Lumens Direct	Lumens Indirect	CCT Available	CRI Available
<b>5x5</b> = 60in by 60in	<b>DR11</b> = 11,800 TL		<b>27</b> = 2700 Kelvins <b>30</b> = 3000 Kelvins <b>35</b> = 3500 Kelvins <b>40</b> = 4000 Kelvins <b>TW</b> = Tunable White 2700-5000 Kelvins	<b>80</b> = 80-85 CRI <b>90</b> = 90-95 CRI
Optics	Mounting	Driver / Voltage	Color	Options
<b>NM</b> = Numat-Stretch Fabric	<b>S</b> = 9/16 Slot Grid <b>T</b> = T-Bar 9/16 and 15/16 <b>FK</b> = Flange (trim) Kit	<b>ND</b> = Non-Dim Universal 120-277VAC <b>ZT</b> = 0-10v Dimming Universal 120-277VAC 1% <b>LE1</b> = Lutron EcoSystem 1% DLC EE CCR / PWM SoftOnFadeToBlack <b>LE5</b> = Lutron EcoSystem 5% DLC EE CCR <b>CC</b> = Custom Control - add in notes	<b>W</b> = Standard White	<b>OS</b> = Occupancy Sensor <b>WH</b> = Whip 6' <b>EMD</b> = Emergency Driver - Battery Backup 120-277VAC

### NOTES

**ORDER NUMBER:**

# Nubez 5x5

RECESSED

TYPE  
PROJECT

## Construction & Mounting

### HOUSING

Excellent design, precision-tooling and automated production is the combination that produces our troffer style housings. Most industry today uses pre-painted, folded 22 gauge steel. We use die formed 20 gauge steel with welded, grinned, sanded corners, that produces a seamless troffer with no light leaks. We manufacture, any size available. Ceiling thickness unrestricted.

### MOUNTING

Our recessed fixtures are made to be mounted in slot grid, T-bar and sheetrock ceilings. See mounting detail. Other ceiling types, please consult the factory, we can accommodate many different applications.

### REFLECTOR

Dual layers of clear and opal white flexible membrane is stretched over the frame. Opal white is to room side.

Integral powder-coated LED housing with excessive reflectivity for increased lumen output

### FINISH

Standard powder-coated colors are white. Troffer style fixtures are not limited to white, consult factory for special applications.

### GRID CEILING INSTALLATION DETAILS

(WHEN ORDERING, PLEASE SPECIFY GRID MANUFACTURER'S GRID TYPE).

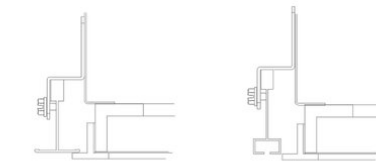

"T"  
15/16" T GRID CEILINGS

"S"  
SLOT GRID CEILINGS

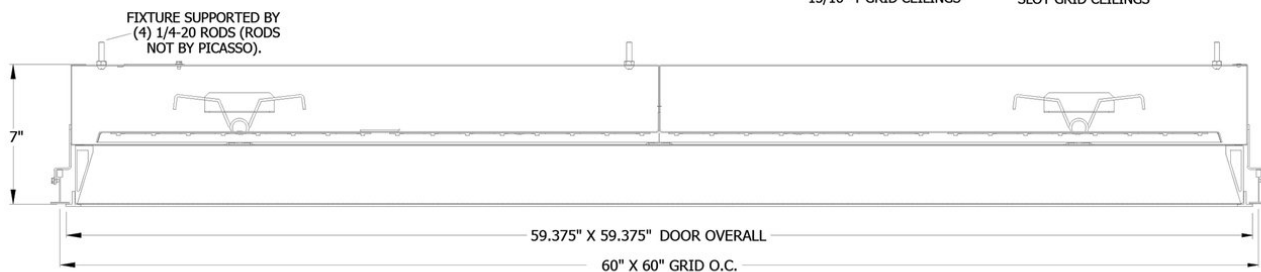

CLIPS SERVE AS A GAUGE TO MAINTAIN PROPER LED TO SHIELDING DISTANCE. CLIPS ARE NOT INTENDED TO SUPPORT FIXTURE.

FIXTURE IS PROPERLY SEATED WHEN CLIPS TOUCH TOP OF GRID. WHEN PROPERLY SEATED, SCREWS IN CLIP SHOULD BE TIGHTENED UNTIL NEAR VERTICAL PART OF GRID.

FIXTURE MUST BE SUPPORTED BY (4) 1/4-20 RODS (RODS NOT BY PICASSO).

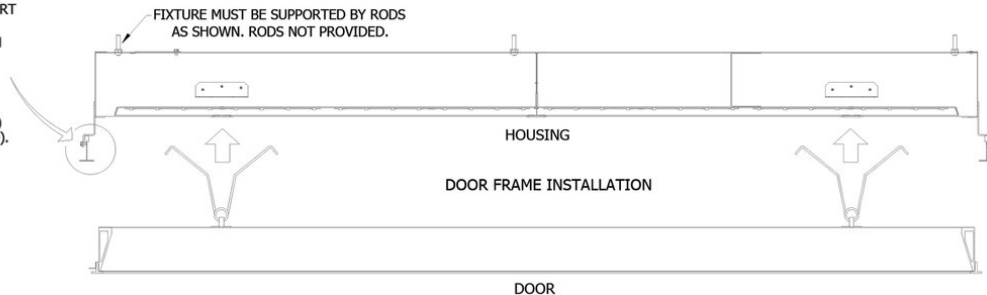

### Electrical / Driver

- Drivers - Our drivers are specifically selected based on fixture application to ensure ultimate reliability and long life. We use only UL recognized brands of LED drivers.
- If required, we can supply premium drivers such as Lutron, Eldoled and others upon request. Advanced control systems compliant drivers such as POE, DALI, DMX, etc. are also available, please consult factory.
- Rated life (90% survivorship) of 50,000 hours at 50° C max. ambient (and 70° C max. case) temperature. At maximum driver load: Efficiency >84%, PF>0.9, THD
- POE - We are working with Igor POE systems to either add a node into our fixtures or remote them. Based on the fixture you select, we will notify you (or you can contact the factory) to see if we can install the node or the node needs to be remote. Just add POE1 in the spec and we will advise. Please keep in mind you need to specify a complete POE control system before specifying POE1.
- Our LED drivers feature HPF (high power factor), universal voltage 110 - 277 VAC and include 0-10V dimming.
- Emergency drivers are factory installed, long life, high temperature, recyclable Ni-Cad battery pack with test switch and charge indicator. EMR is minimum of 90 minutes operation to meet code.
- Whip - Six feet long, wiring RHOS/Reach Compliant, 18 gauge, 600v rated, Supplied, wired to the fixture, unless otherwise noted.

### LED Performance

LED Output	CCT Color Temp	Watts	Lumens	Lumens per Watt	CCT Multiplier
Medium	3000	4.88 WPSF	473 LPSF	97 LPW	2700=.95/3000=1 /3500=1.01/4000/1.03

- The table above is a quick reference. When calculating loads make sure you add direct and indirect LPW to get total wattage. Please refer to photometric report for detailed information.
- Our light engines are precisely designed for optimal operation of LED assemblies.
- Our standard LED's CCT (correlated color temperature) range is 2700K to 4000K. Other CCT values are available upon request.
- We log LED bin codes for each project we supply to ensure color consistency and keep a record of those projects for future reference.
- CRI offered is 80+, and 90+ Note: on 90+ CRI use .85 multiplier
- Tunable white, warm dim and other special LED colors available.
- We design our own printed circuit boards to ensure high luminescence efficiency, low thermal resistance and long-term reliable operation.
- Light engines are easily replaced.
- We use only recognized brand LED's with 3 SDCM (standard deviation color matching) with high color consistency. 2 SDCM available upon request.
- LRP - "LED Reel Program" – LED's for printed circuit boards come on reels' like old 8mm projectors and they're sold in lots just like fabric. At Picasso Lighting, we have a program where we make sure all of your reels come from the same lot for each project. This ensures excellent color consistency in large open spaces.
- LED life is rated at 50,000 hours
- Custom Lumens Available

### Certifications & Warranties

- Limited five-year (50,000 hours) warranty on all products.
- I.C. rated fixtures are available upon request.
- All fixtures are IBEW manufactured and assembled.
- UL and CUL listed for dry and damp locations.
- Chicago Plenum products are available upon request.
- Made in the U.S.A.



Note: Picasso lighting industries, LLC reserves the right to make any design changes which will not affect the overall appearance or performance of the product. All ceilings to be adequately reinforced by others. All fixtures to be wired by licensed electrician only. The information contained herein is the sole property of Picasso Lighting Industries, LLC and may not be used without prior written consent of Picasso Lighting Industries, LLC. The 'USGBC member logo' is a trademark owned by the U.S. Green building council and is used by permission. The logo signifies only that Picasso Lighting Industries, LLC is a USGBC member; USGBC does not review, certify, or endorse the products or services offered by its members.